

See
D. 286

pg- 379

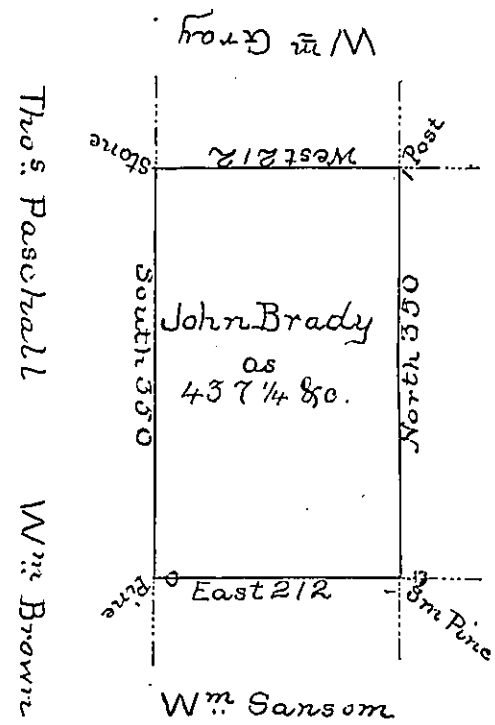

(Don't Use)

Draft of a tract of land called *Situate*
 joining land surv^d for Tho^s Paschall in the
 County of Northum^d containing four hundred
 & thirty seven acres $\frac{1}{4}$ & allowance surveyed for
 John Brady the 20th Day of Sep^r 1793 by virtue
 of a warrant dated the 2^d day of August 1793
 by Wm Gray D.S.

To
 Daniel Brodhead Esq^r
 Surv^r Gen^l }

IN TESTIMONY that the above is a copy of the original remaining on file in the
 Department of Internal Affairs of Pennsylvania, made con-
 formably to an Act of Assembly approved the 16th day of
 February, 1833, I have hereunto set my Hand and caused
 the Seal of said Department to be affixed at Harrisburg, this

sixth day of July 1834

J. Simpson Africa
 Secretary of Internal Affairs